



• 10305 I.H. 35 N. • SAN ANTONIO • TEXAS 78233 • PH 210-654-7171

INSTALLATION INSTRUCTIONS

1969 FIREBIRD without

FACTORY AIR

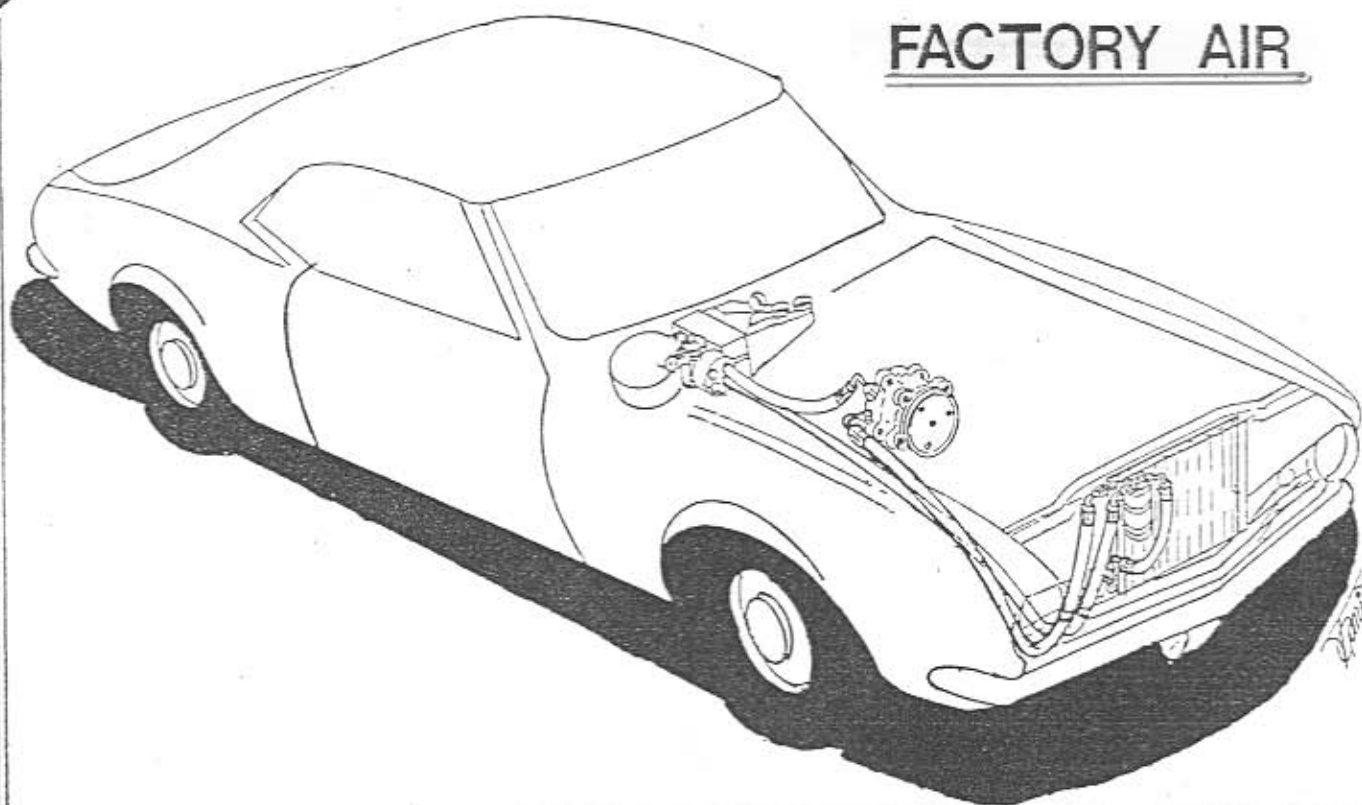

For maximum system performance Vintage Air recommends the following:

1. 18" Heavy-Duty Fan (V.A.PN:32618-VUF) or OEM style clutch fan
2. Fan Shroud

REFRIDGERATION CAPACITIES:	R-134a	1.8 lbs.
	R-12	2.0 lbs.

LUBRICANT CAPACITIES:	NEW COMPRESSOR - NO ADDITIONAL OIL NEEDED
	USED COMPRESSOR - CONSULT VINTAGE AIR

INSTALLATION INSTRUCTIONS 1969 FIREBIRD

BEFORE STARTING THE INSTALLATION, CHECK THE FUNCTION OF THE VEHICLE (HORN, LIGHTS, ETC.) FOR PROPER OPERATIONS. STUDY THE INSTRUCTIONS AND ILLUSTRATIONS DIAGRAMS. DISCONNECT BATTERY.

PASSENGER COMPARTMENT

REMOVE THE FOLLOWING (FIGURE 1)

1. Remove glove box door.
2. Remove and discard OEM glove box.
3. Remove steering column bottom cover.
4. Drop down steering column.
5. Remove instrument panel.
6. Remove and discard driver side vent duct.
7. Remove and discard passenger side vent duct.
8. Remove and discard the OEM heater cover (engine side).
Inner fender must be loosened and lowered to gain access to the heater cover bolts.
9. Remove and discard the OEM heater assembly.
10. Remove and discard the OEM defroster duct.

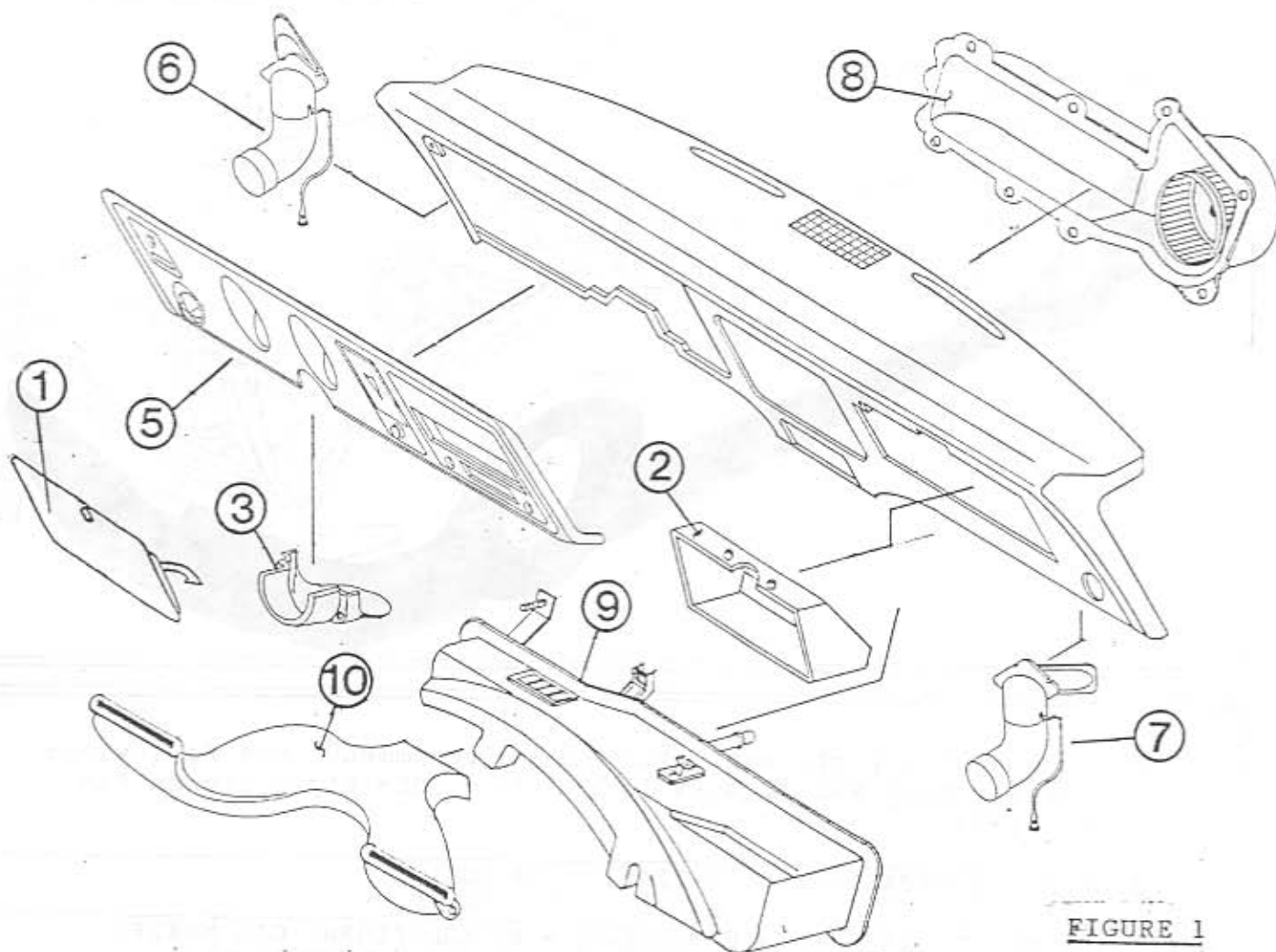

FIGURE 1

INSTALL THE FOLLOWING (Figure 2):

1. Fresh Air Covers- Install the fresh air covers in place of the original side vent holes using the original screws.
2. Defroster Ducts- Locate the defroster ducts; mark and drill the mounting holes. Install the driver side duct using two #8 x $\frac{1}{2}$ " pan head screws (supplied). The passenger side defroster duct will be installed after the evaporator.
3. Firewall Cover- Mount the firewall cover to the original heater mounting holes with $\frac{1}{4}$ " x 1" bolts and washers (supplied).

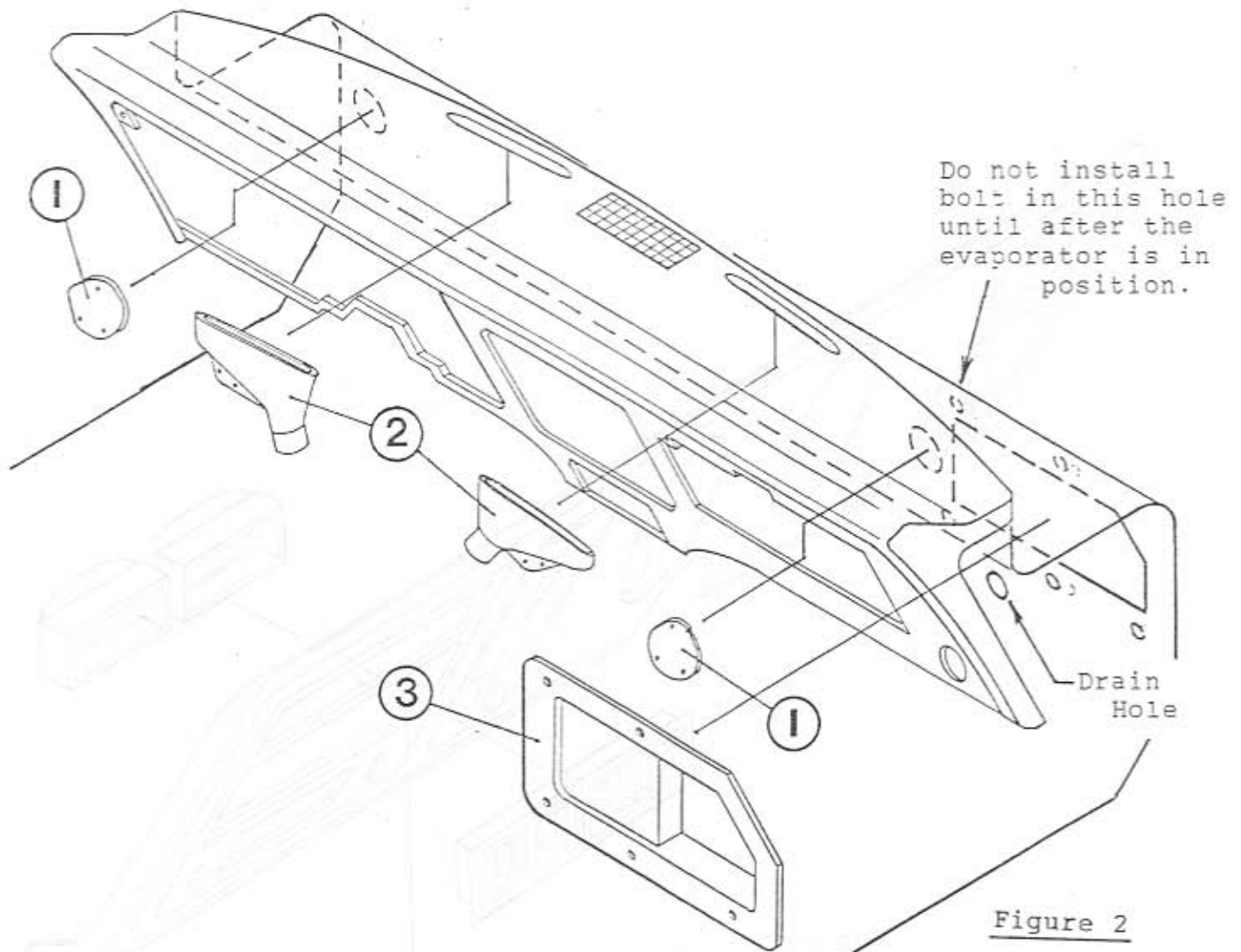

Figure 2

4. Drain Hole- Drill $\frac{5}{8}$ " hole through the firewall located one inch below the firewall cover, 2" towards the driver side from the center bolt. This hole will be used later for the evaporator drain hose.

5. Center Louvers-

- a) Using the cut-out template included with these instructions (p.12), mark your dash in the location shown below.
- b) Cut out the marked area.
- c) Install the Vintage Air louvers as shown.

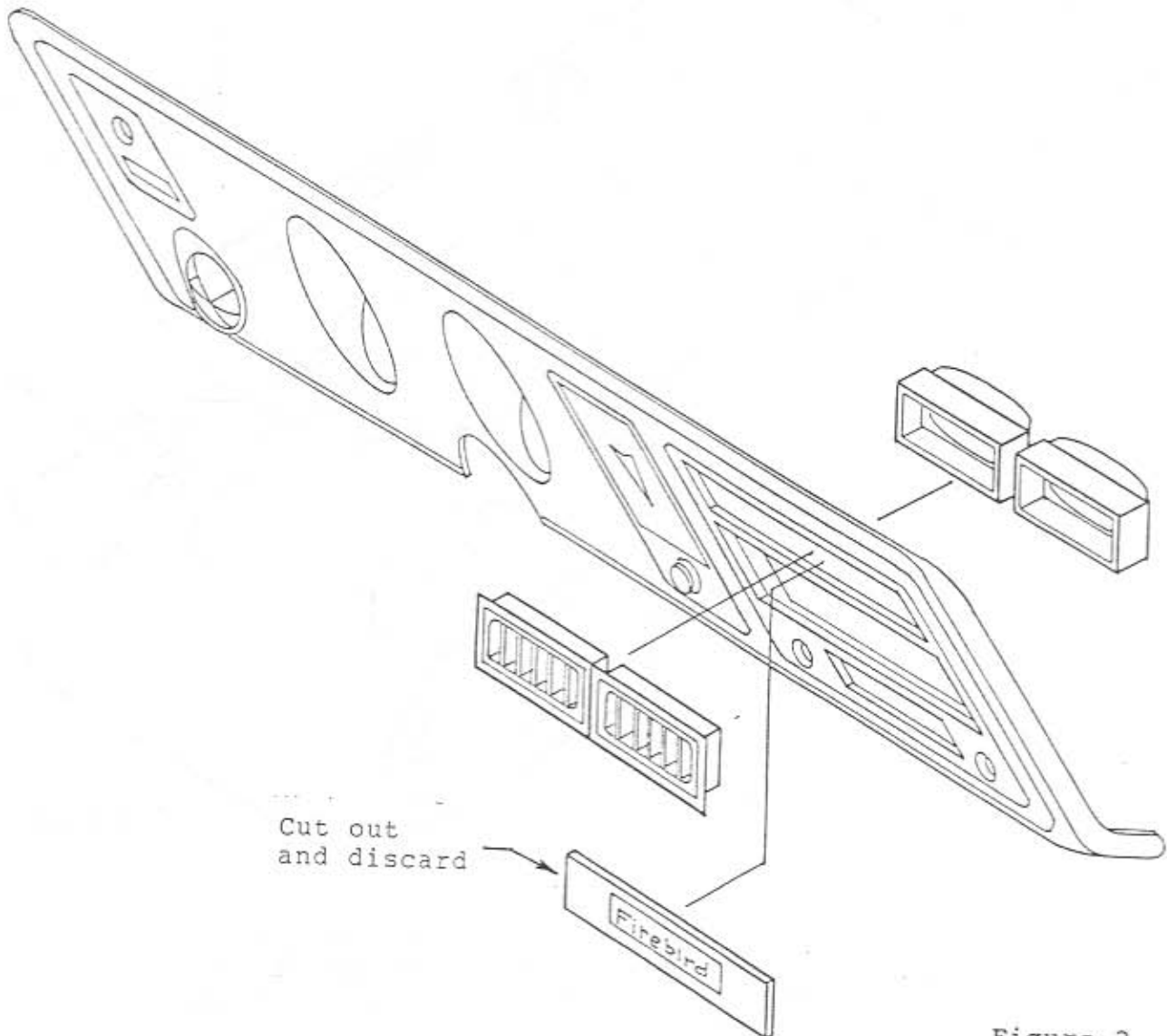

Figure 3

EVAPORATOR INSTALLATION

A. Mounting Brackets

1. Locate and support evaporator in place under dash.

NOTE: For easier installation, install a stud into the jack nut in the back of the unit, then insert the stud through the open hole in the firewall cover to position the unit.

2. Install mounting brackets to the unit as shown below.
3. Mount the blower housing bracket to the firewall with the top screw in the passenger side fresh air cover.
4. Position the center mount bracket and drill the required holes. This bracket will be mounted beneath the passenger side defrost duct with two #8 x $\frac{1}{2}$ " pan head screws (supplied). Install the passenger side defrost duct after final installation of the unit.
5. Install $\frac{1}{4}$ " x 1" bolt through firewall into back of evaporator (after removal of stud, if used).
6. Attach drain hose to the bottom of the evaporator and route through the $\frac{5}{8}$ " firewall hole drilled earlier.

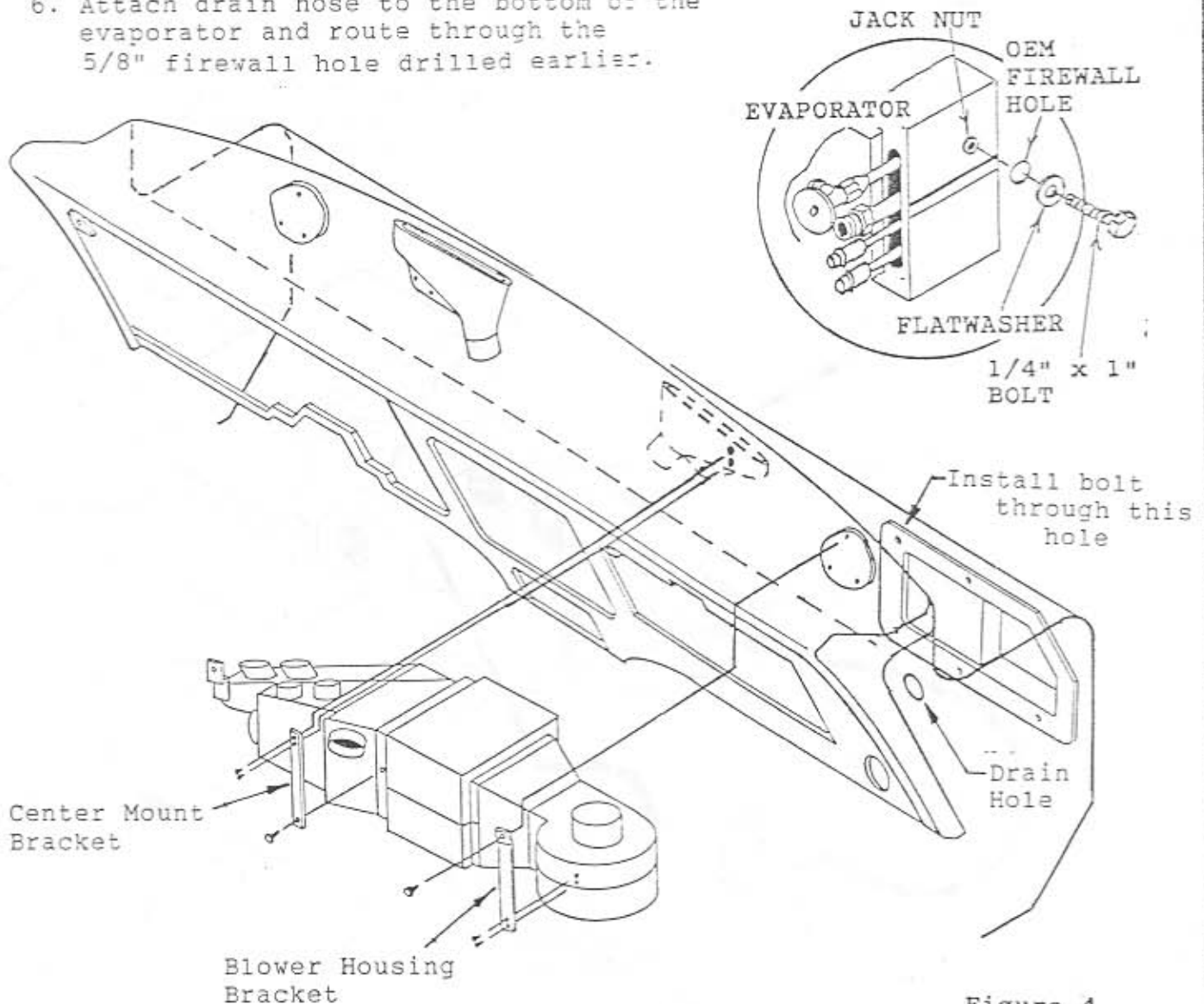

Figure 4

To Defrost
Control Door

Remove and
discard cable
from this post

To Temperature
Control Door

To Blower (OEM Wire Harness)

Top

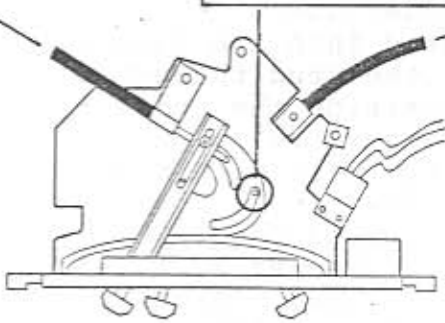

Front

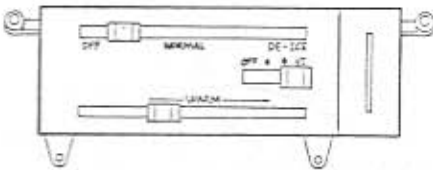

Bottom

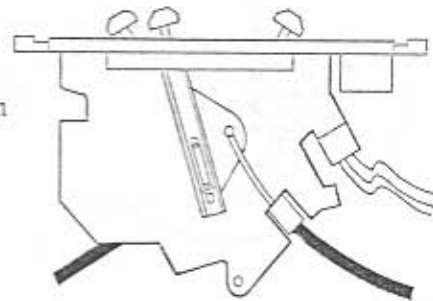

B. Control Cables

1. Remove and discard the cable indicated in figure 6.
2. Install the top cable onto the defrost door lever arm.
3. Install the bottom cable onto the a/c door lever arm.

NOTE: Control cable installation may require the evaporator unit to be lowered for better access.

OEM Control Panel
(Figure 6)

Defrost
Control Door

Temperature
Control Door

EVAPORATOR

Temperature Control
Cable (19½")

Defrost Control
Cable (26")

Figure 5

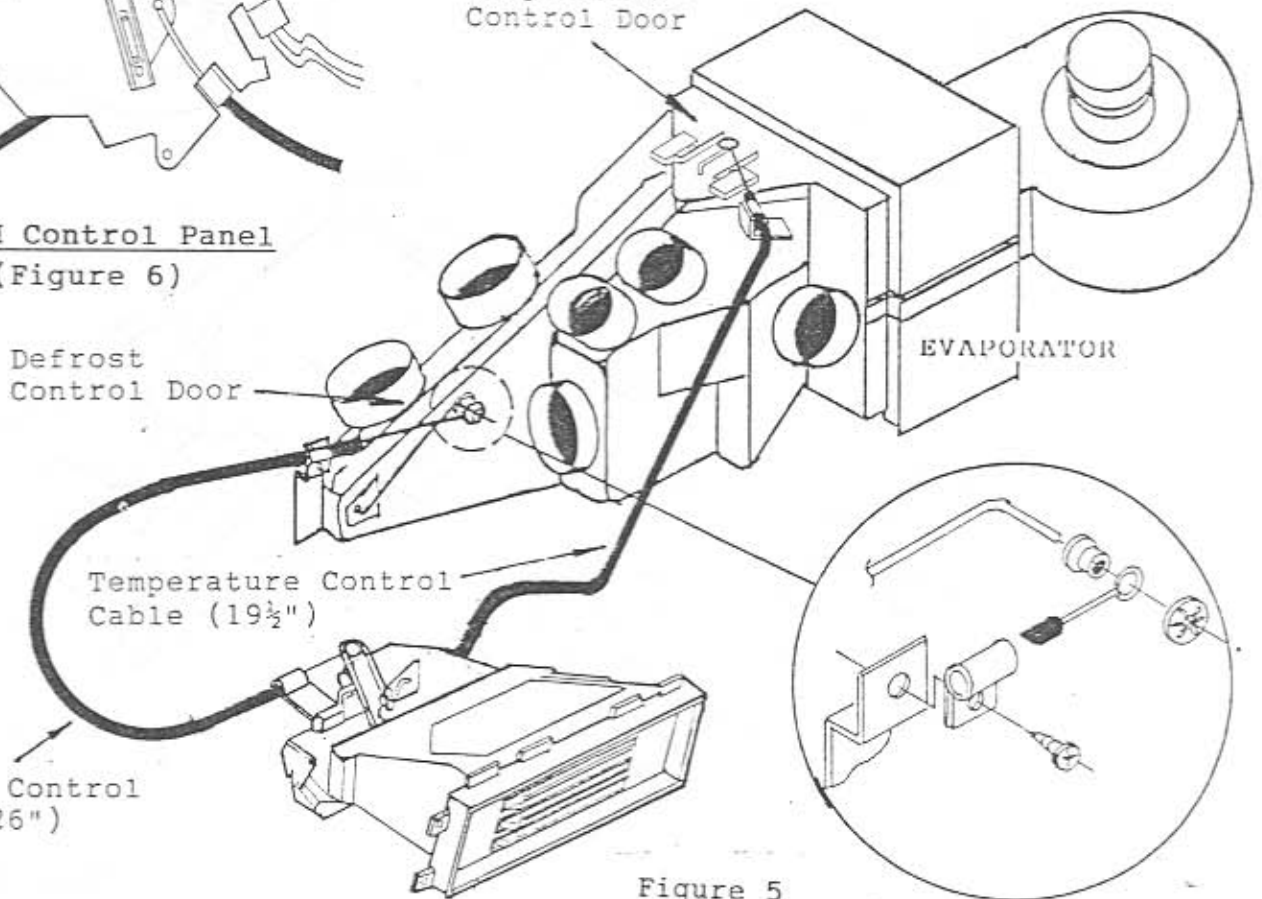

C. Duct Hoses

1. Cut the duct hoses according to the lengths given in Figure 7.

NOTE: With the unit in place, stretch the duct hoses tightly to their corresponding outlets and recheck the lengths. A minimum number of kinks and sharp bends will insure maximum air flow.

2. Install 2" defroster duct hoses first.
3. Route the driver side a/c duct hose (2½") behind the steering column support brackets.
4. Route the passenger side a/c duct hose (2½") behind the blower housing bracket. Leave enough length for this hose to be routed over the top of the glove box.
5. Secure the two side a/c hoses to the hose adapters with at least two #6 screws.
6. Attach the hose adapters to the OEM louvers, and install the louvers into the dash.
7. Install the center a/c duct hoses (2") to the center louvers.

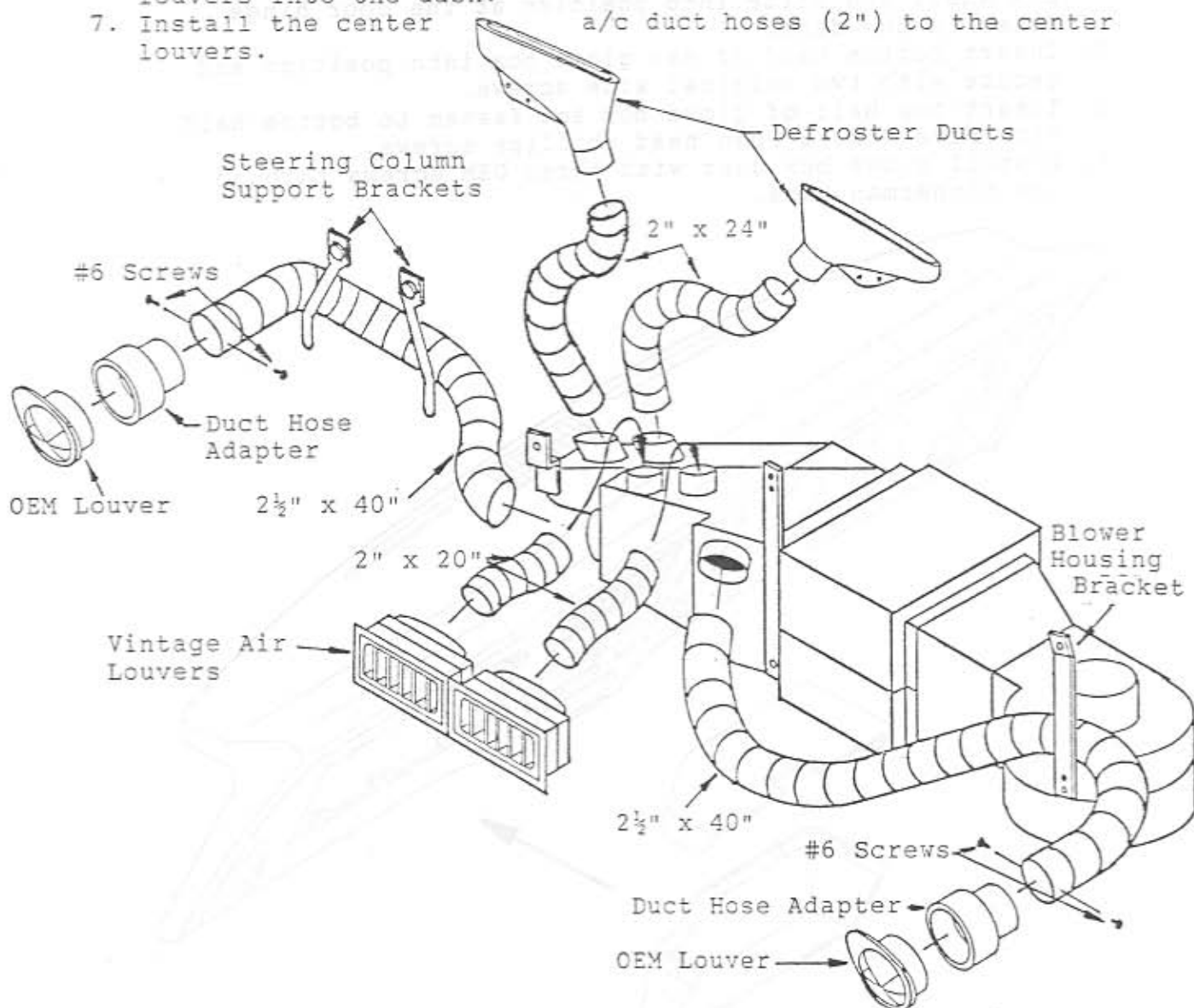

Figure 7

D. Wiring Procedure (See Wiring Diagram, p.10)

1. Connect blower motor wires to the OEM blower motor harness.
2. Ground the blower motor and the heater valve vacuum solenoid.
3. Route the blue compressor lead and the vacuum hoses through the firewall cover.

GLOVE BOX INSTALLATION

1. Remove the three tinnerman nuts from the original glove box shell and slide into position at the door hinge holes in the dash.
2. Insert bottom half of new glove box into position and secure with two original side screws.
3. Insert top half of glove box and fasten to bottom half with five #6x3/8" pan head phillips screws.
4. Install glove box door with three OEM screws through the tinnerman nuts.

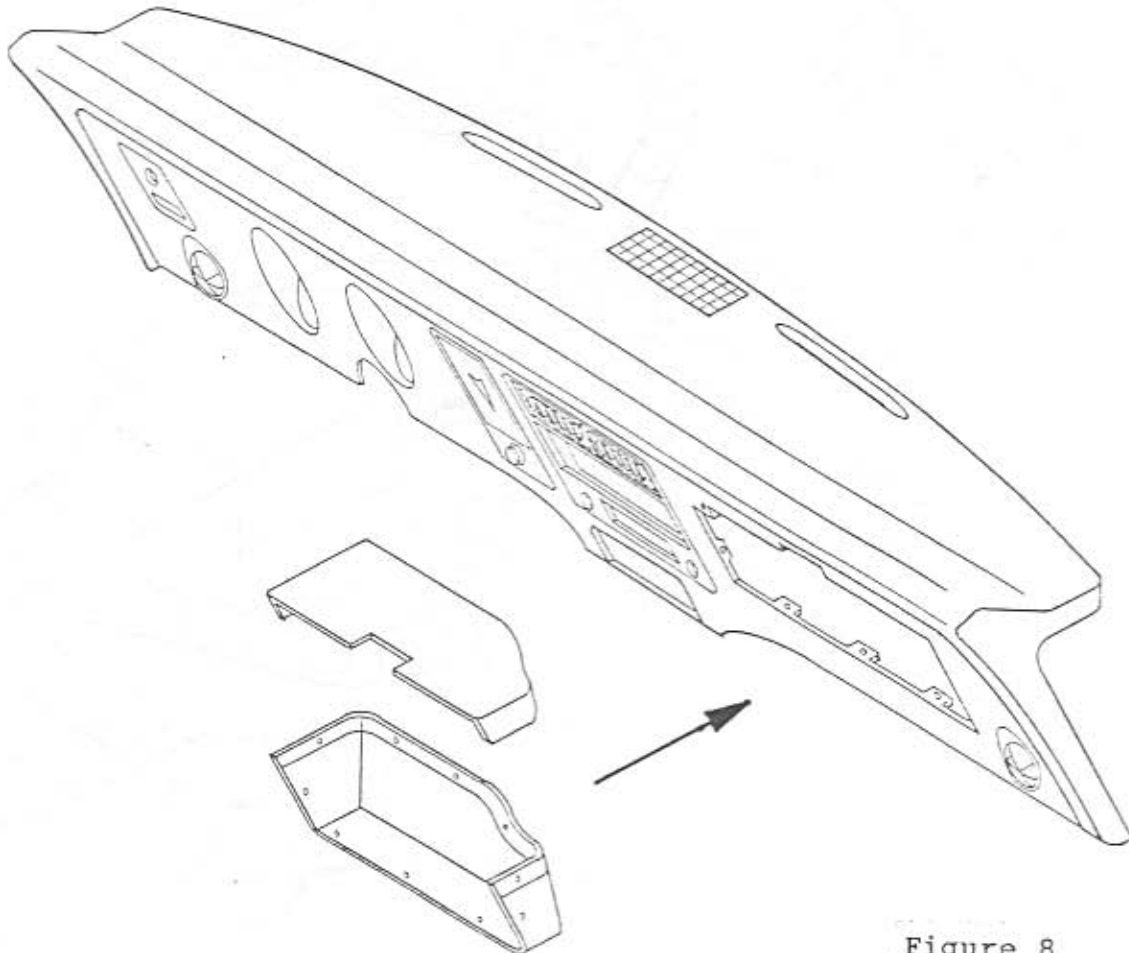

Figure 8

ENGINE COMPARTMENT

1. Remove hood latch assembly for installation of condenser as Figure 9 shows.
2. Install condenser assembly on radiator bulkhead using (4) 1/4"-20 x 1/2" bolts, flatwashers and nuts as Figure 11 shows.
3. Install the firewall fresh air cover over the OEM blower motor hole as shown in the figure below.

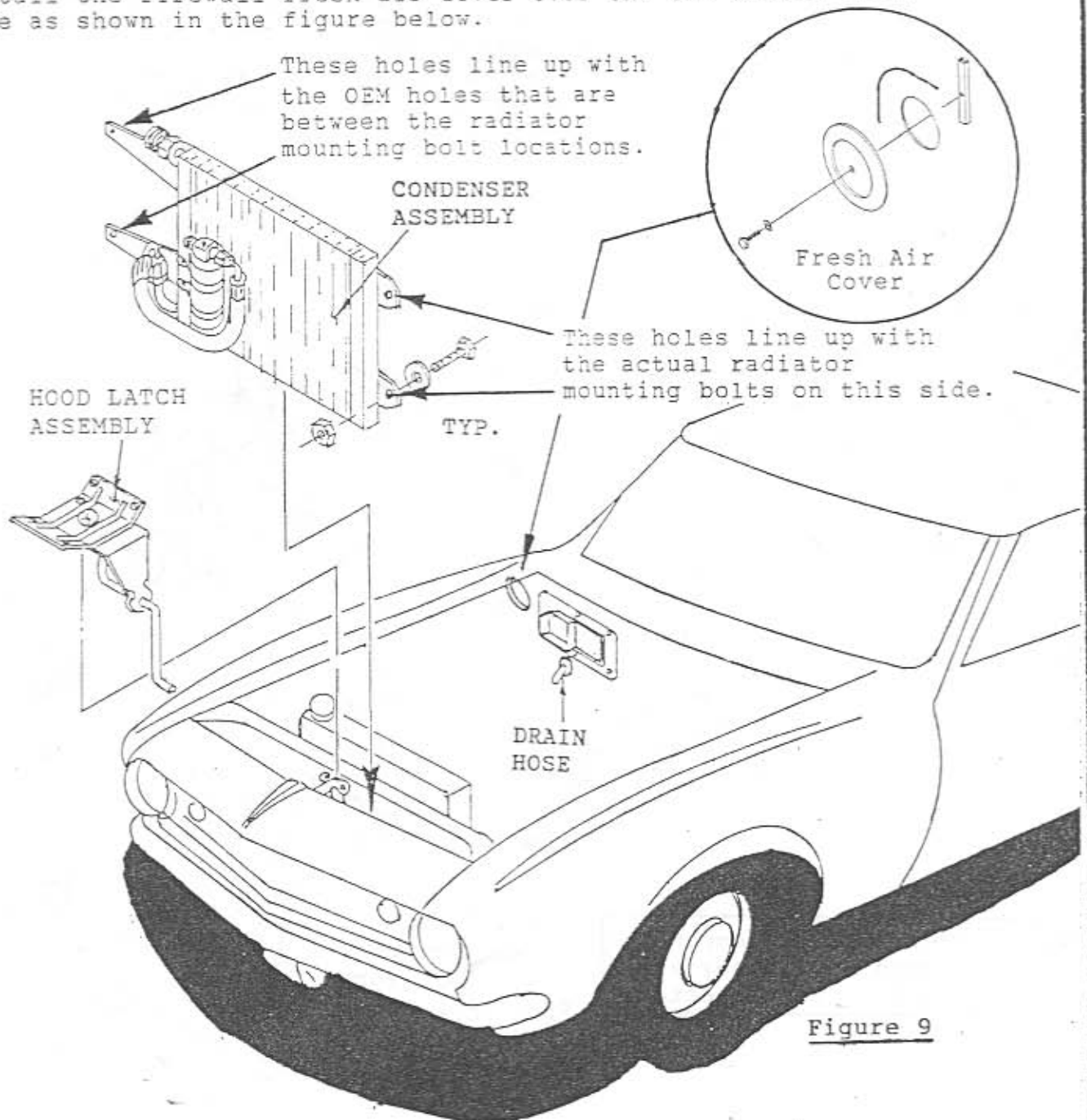

Figure 9

AC and HEATER HOSE INSTALLATION

NOTE: Lubricate all A/C hose o-rings prior to installation.

1. Insert heater hoses and #6 & #8 A/C hoses through hose grommet; attach hoses to evaporator.
2. Insert vacuum hoses and compressor lead through hose grommet.
3. Slide hose grommet over firewall cover and secure with sheetmetal screws.
4. Install A/C hoses as shown below:
 - #10) Evaporator to compressor
 - #8) Compressor to condenser
 - #6) Drier to compressor
5. Connect the compressor lead to the binary switch, and from the binary switch to the compressor clutch.
6. Install the heater hoses and the vacuum hoses as shown below.
7. Evacuate system for at least 30 minutes; charge according to capacities given on the cover.

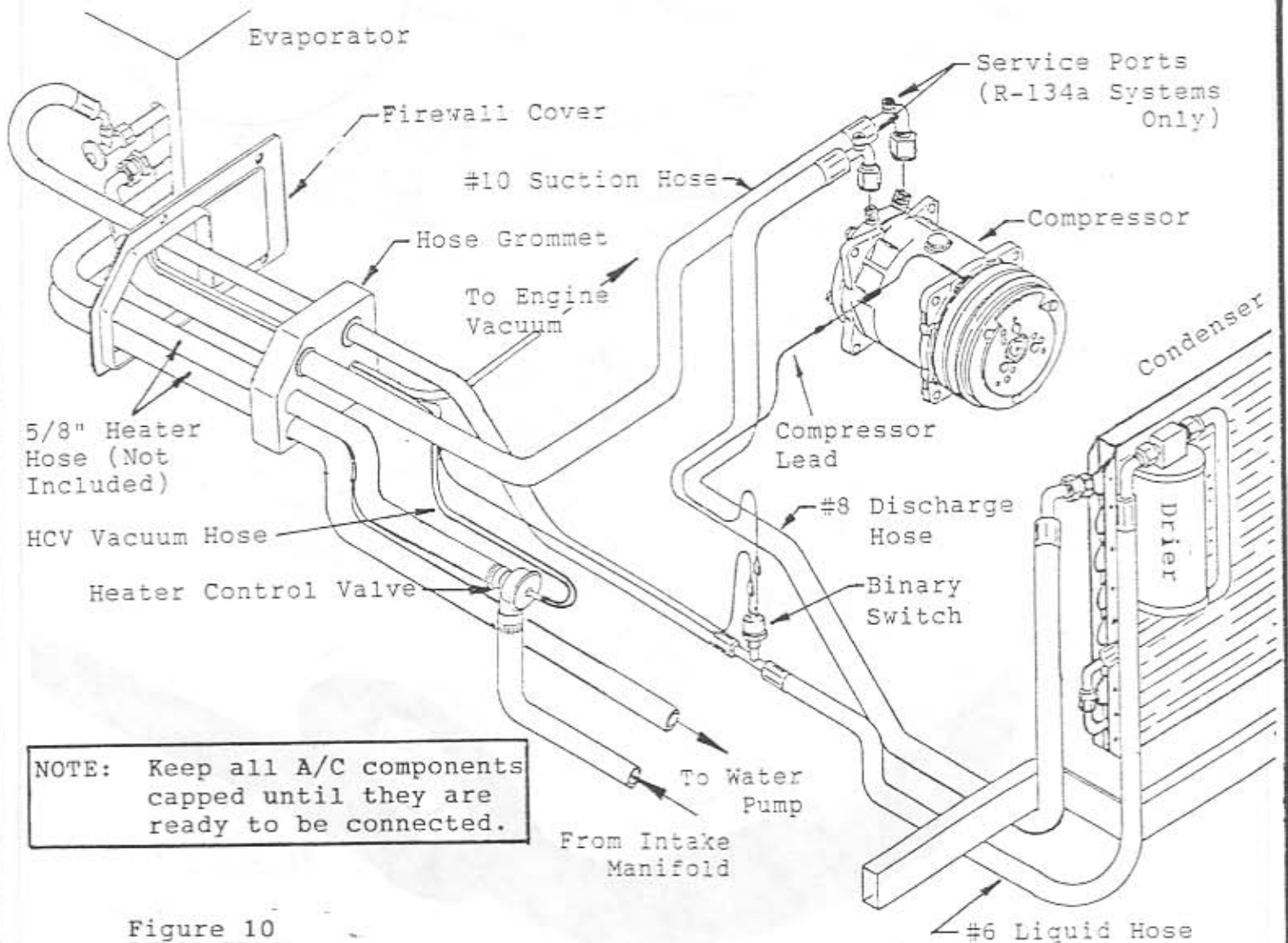
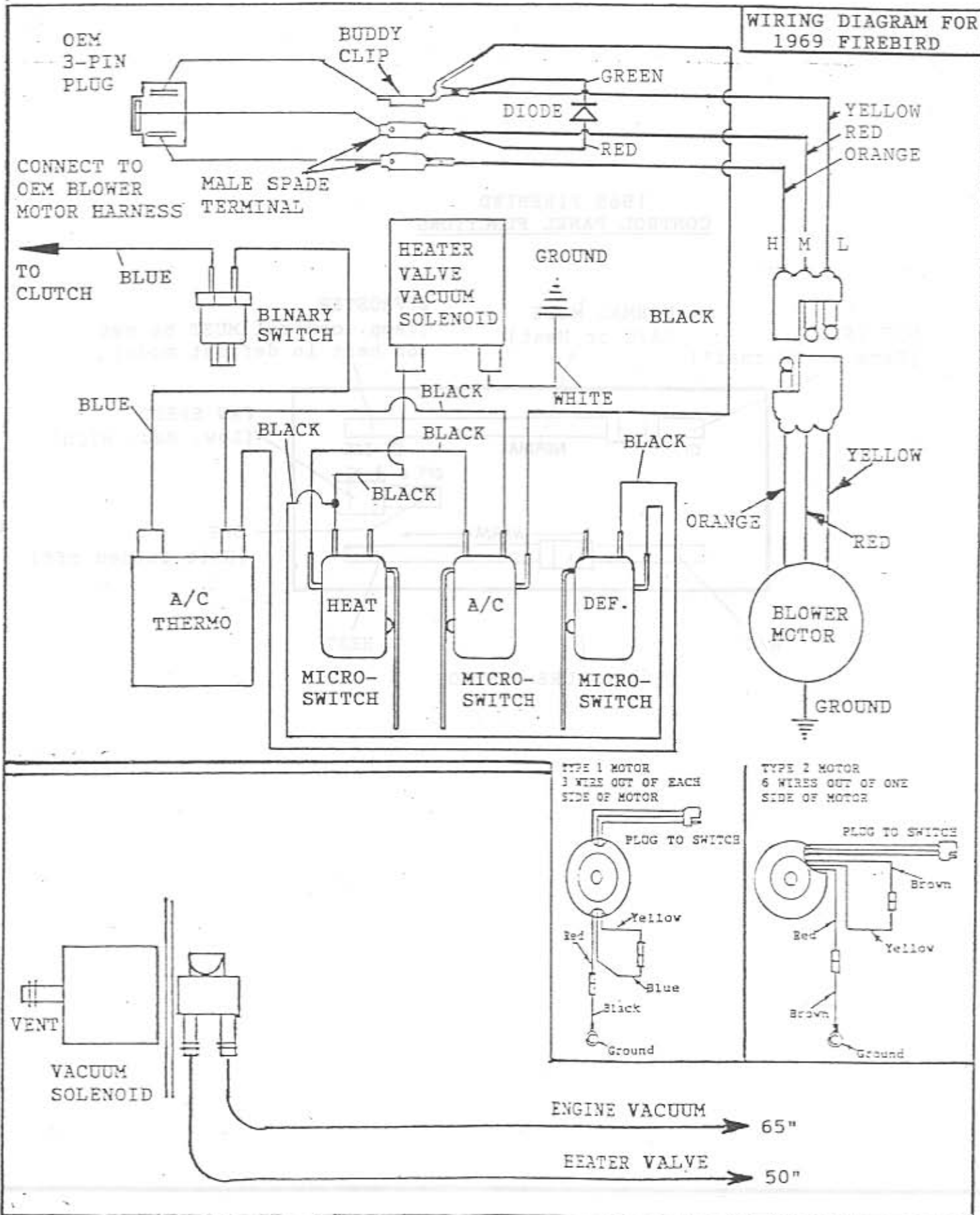
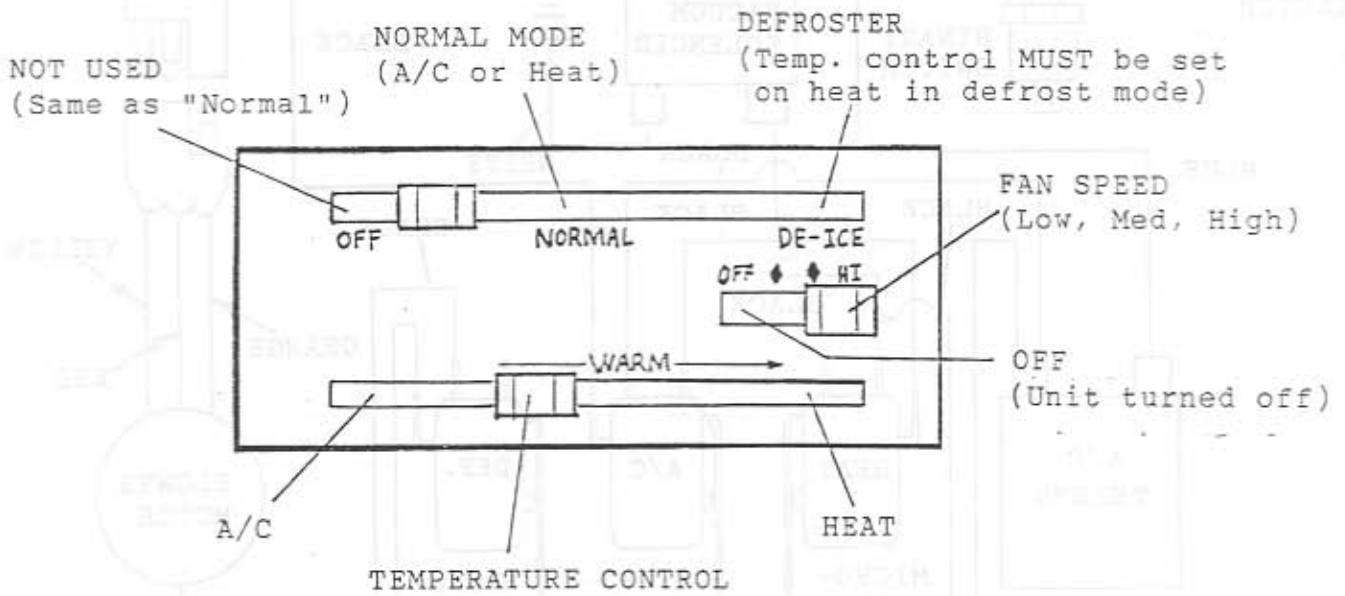

Figure 10

WIRING DIAGRAM FOR 1969 FIREBIRD



1969 FIREBIRD
CONTROL PANEL FUNCTIONS



$\frac{1}{2}$ " SPACER L.V.R

$\frac{1}{2}$ " TAPER

DASH CUT-OUT TEMPLATE
FOR CENTER LOUVERS

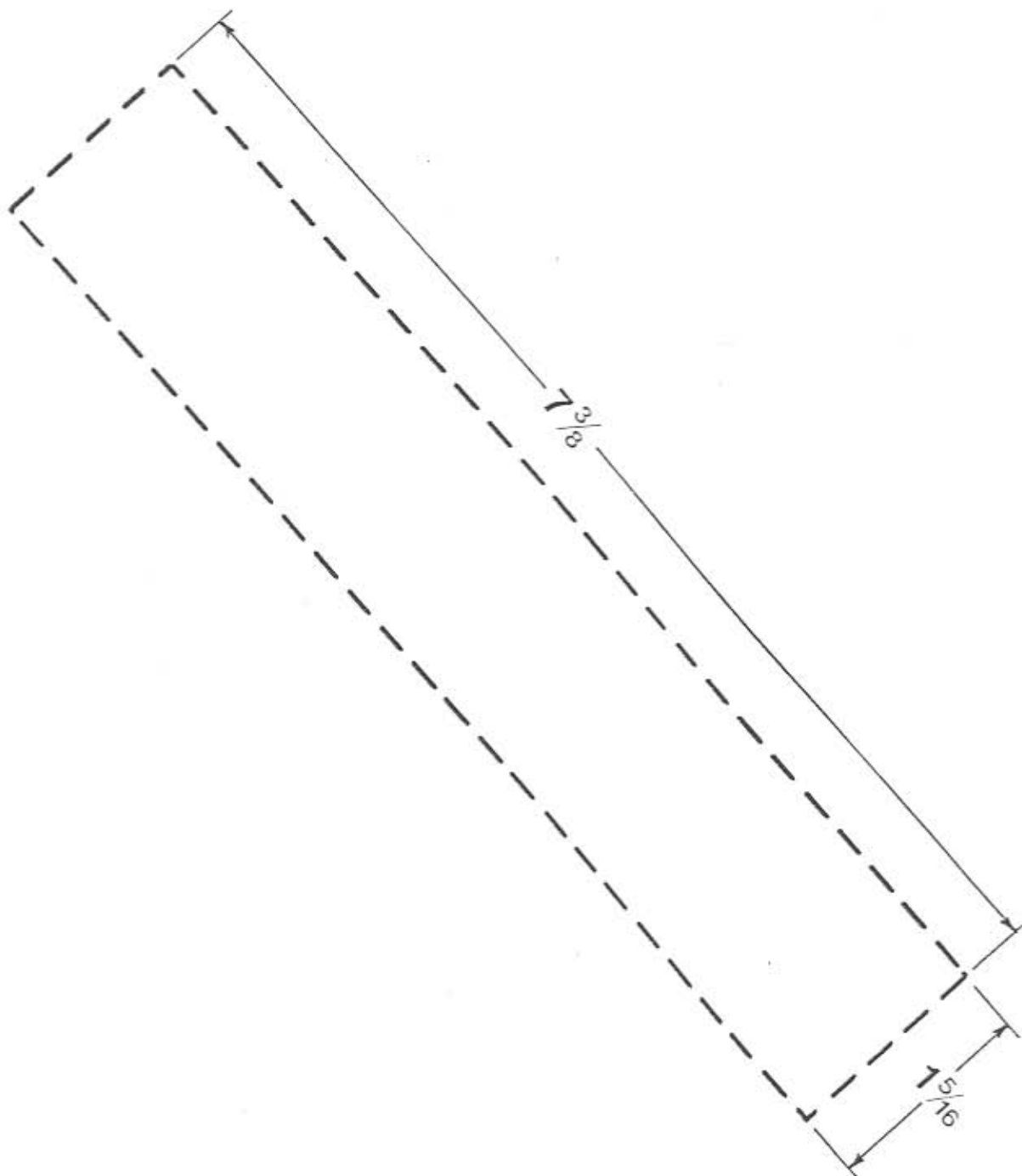

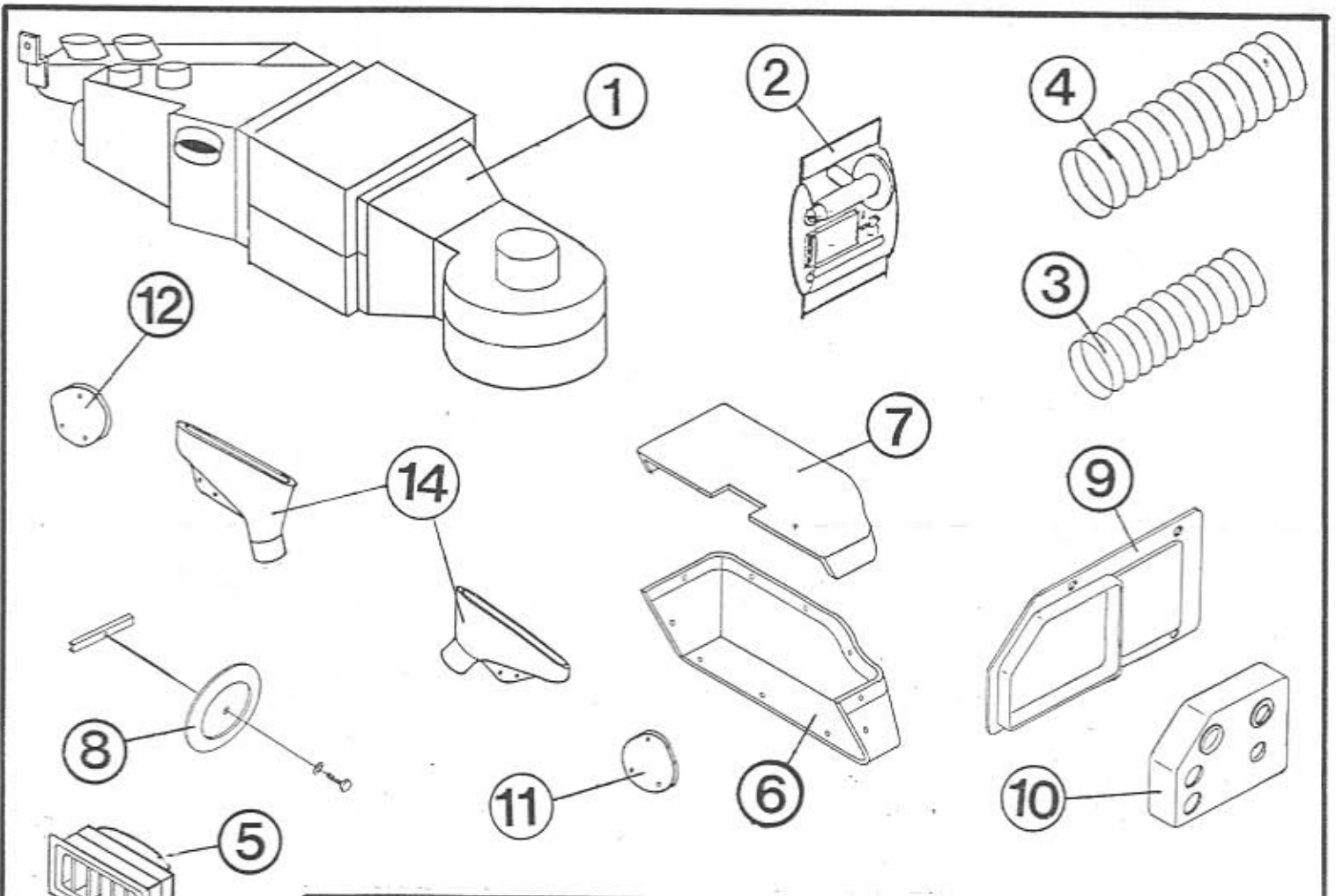

D.O.# _____

**1969 Firebird w/out Factory Air
Packing List (55067-VPZ)**

NO	QTY	PART NUMBER	DESCRIPTION
1	1	55354-VPE	Evaporator Unit
2	1	63283-VCE	Drain Kit Baggie
3	1	06200-VUE	Duct Hose (2"x88")
4	1	06250-VUE	Duct Hose (2½"x80")
5	2	49256-VUL	Center Louver
6	1	49067-VCI	Glove Box Bottom
7	1	49068-VCI	Glove Box Top
8	1	49864-VCI	Firewall Fresh Air Cover w/Bracket
9	1	62220-VCI	Firewall Cover
10	1	62221-VCI	Firewall Cover Hose Grommet
11	1	62272-VPE	Passenger Side Fresh Air Cover
12	1	62273-VPE	Driver Side Fresh Air Cover
13	2	62274-VPE	Side Vent Hose Adaptor
14	1	63390-VPE	Pair of Defrost Ducts
15	1	64065-VCB	Blower Housing Bracket
16	1	64132-VFE	Center Mount Bracket

Date : _____
Checked : _____
Packed : _____

